

LEGEND

	STONE WALL
	PROPERTY LINE
	STREET LINE
	EXISTING CONTOUR
	STREET ADDRESS
	BUILDING SETBACK LINE
	EDGE OF FLAGGED WETLANDS
	SILT FENCE/HAYBALES OR WOODCHIPS
	DRILL HOLE FOUND

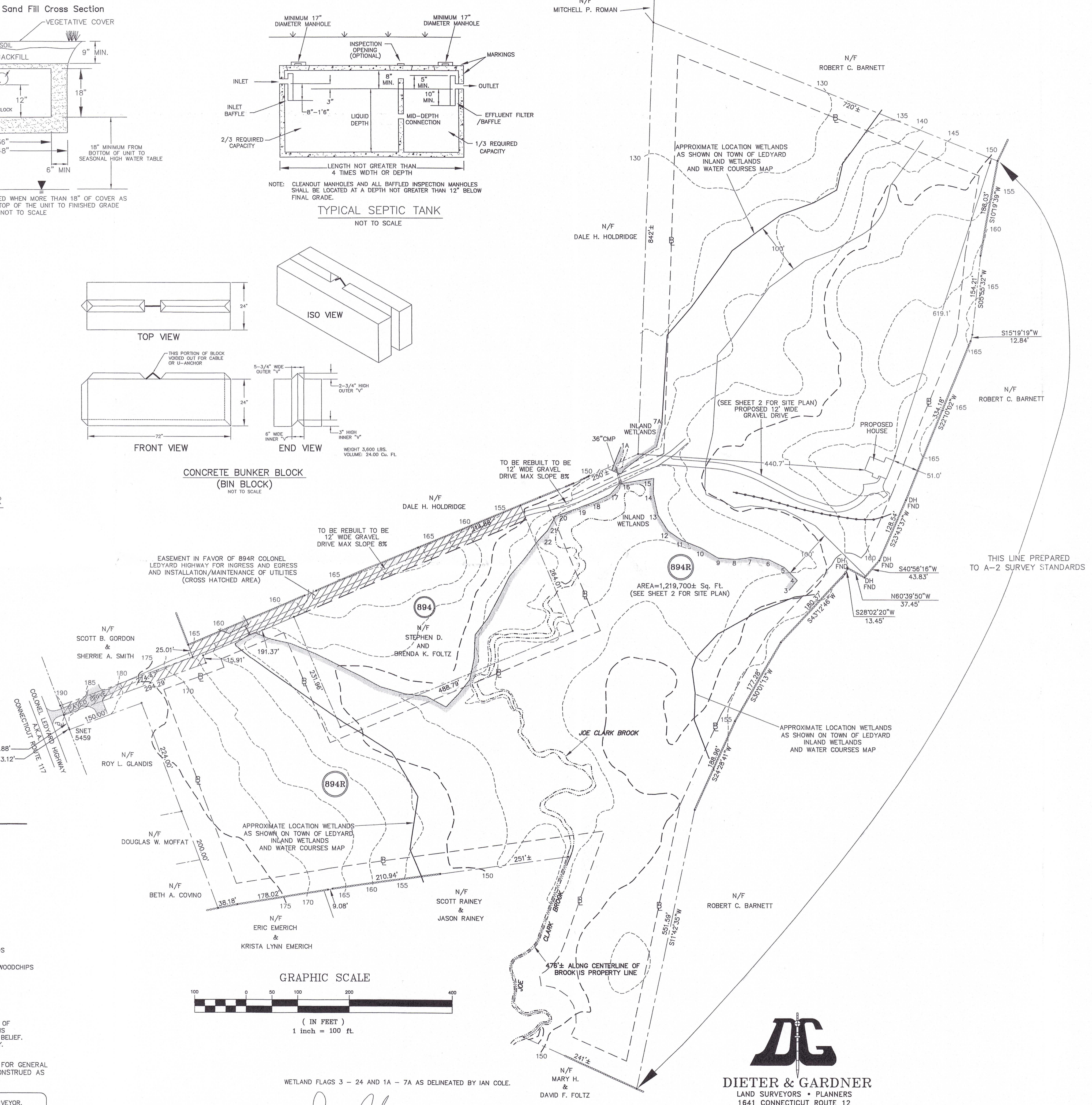
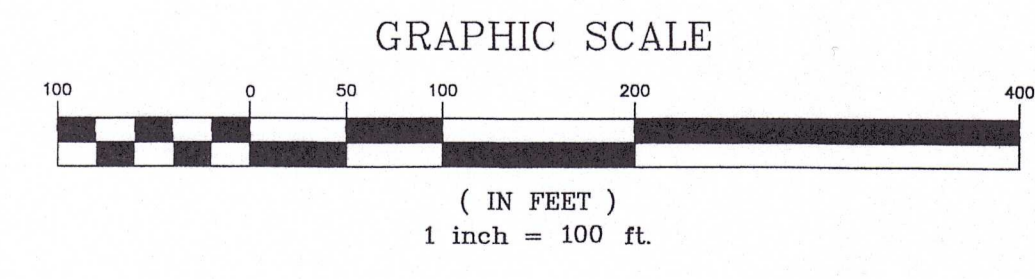

THE WORD "CERTIFY" IS UNDERSTOOD TO BE AN EXPRESSION OF THE PROFESSIONAL OPINION BY THE LAND SURVEYOR WHICH IS BASED ON HIS OR HER BEST KNOWLEDGE, INFORMATION AND BELIEF, AS SUCH IT CONSTITUTES NEITHER GUARANTEE OR WARRANTY.

NOTE: BOUNDARY LINES OF ADJOINING PROPERTIES ARE SHOWN FOR GENERAL INFORMATIONAL PURPOSES ONLY AND ARE NOT TO BE CONSTRUED AS BEING ACCURATELY LOCATED OR DEPICTED.

THIS DRAWING IS THE PROPERTY OF THE LAND SURVEYOR. THIS PLAN AND REPRODUCTIONS, ADDITIONS OR REVISIONS OF THIS PLAN ARE NOT VALID WITHOUT THE EMBOSSED SEAL AND SIGNATURE OF THE LAND SURVEYOR WHO PREPARED THIS PLAN. JOB# 21-042.DWG FBK#317

THE STONE WALLS AND/OR FENCES SHOWN AS BOUNDARIES MAY HAVE IRREGULARITIES OF COURSE BETWEEN PRINCIPAL POINTS OF COURSE INDICATED

IAN COLE
SOIL SCIENTIST

DIETER & GARDNER
LAND SURVEYORS • PLANNERS
1641 CONNECTICUT ROUTE 12
P.O. BOX 335
GALES FERRY, CT. 06335
(860) 464-7455
EMAIL: DIETER.GARDNER@YAHOO.COM

RECEIVED
JUL 13 2022
BY: *[Signature]*
Name: *[Signature]*

MAP REFERENCE
A) CONNECTICUT MAP TOWN THE OLD ROAD DATE 6-30-00
B) F & H SURVEY F. FOLTZ ET AL ACRES DATE 1-27-00
C) PLAN SHOWING DOROTHY A. LEDYARD HI SCALE: 1"=40'
D) PLAN SHOWING D. BARNETT AS SHOWN
E) LIMITED PREPARED SUBDIVISION PREPARED DATE 1-27-00
F) PLAN SHOWING MARY H. FOLTZ A.K.A. CONN. DATE 29, 2015
G) BOUNDARY AND ROBERT CONNECTICUT

EXCAVATE UNSUITABLE MATERIAL & TOPSOIL, REPLACE WITH COMPACTED BANK RUN GRAVEL

GRAVEL DRIVE

NOTE: DRIVEWAY TO 894R COLONEL ACCORDANCE WITH SECTION

SHEET 1 - 100 SCALE MAP
SHEET 2 - 30 SCALE SITE

PLAN
PROPOSED
JACOB
MARY I
894R COLONEL
CONNECTICUT
LEDYARD,
SCALE
APPROXIMATE
REVISION

THIS SURVEY AND MAP HAS BEEN PREPARED THROUGH THE USE OF THE REVISIONS THROUGH 20-3006-20 OF THE REVISIONS OF THE STANDARDS FOR SURVEYS AND MAPPING OF THE CONNECTICUT ASSOCIATION OF LAND SURVEYORS ON A RESURVEY CONFORMING TO THE T-D. TO MY KNOWLEDGE AND BELIEF.

TITLE: LAND SURVEYOR CT
DATE: APRIL 18, 2022