

**Note**

**E3608.1.2 Concrete-encased electrode.** A concrete-encased electrode consisting of at least 20 feet (6096 mm) of either of the following shall be considered as a grounding electrode:

- One or more bare or zinc galvanized or other electrically conductive coated steel reinforcing bars or rods not less than 1/2 inch (13 mm) in diameter, installed in one continuous 20-foot (6096 mm) length, or if in multiple pieces connected together by the usual steel tie wires, electric welding, or other effective means to create a 20-foot (6096 mm) or greater length.
- A bare copper conductor not smaller than 4 AWG.

Metallic components shall be encased by at least 2 inches (51 mm) of concrete and shall be located horizontally within that portion of a concrete foundation or footing that is in direct contact with the earth or within vertical foundations or structural components or members that are in direct contact with the earth.

Where multiple concrete-encased electrodes are present at a building or structure, only one shall be required to be bonded into the grounding electrode system.

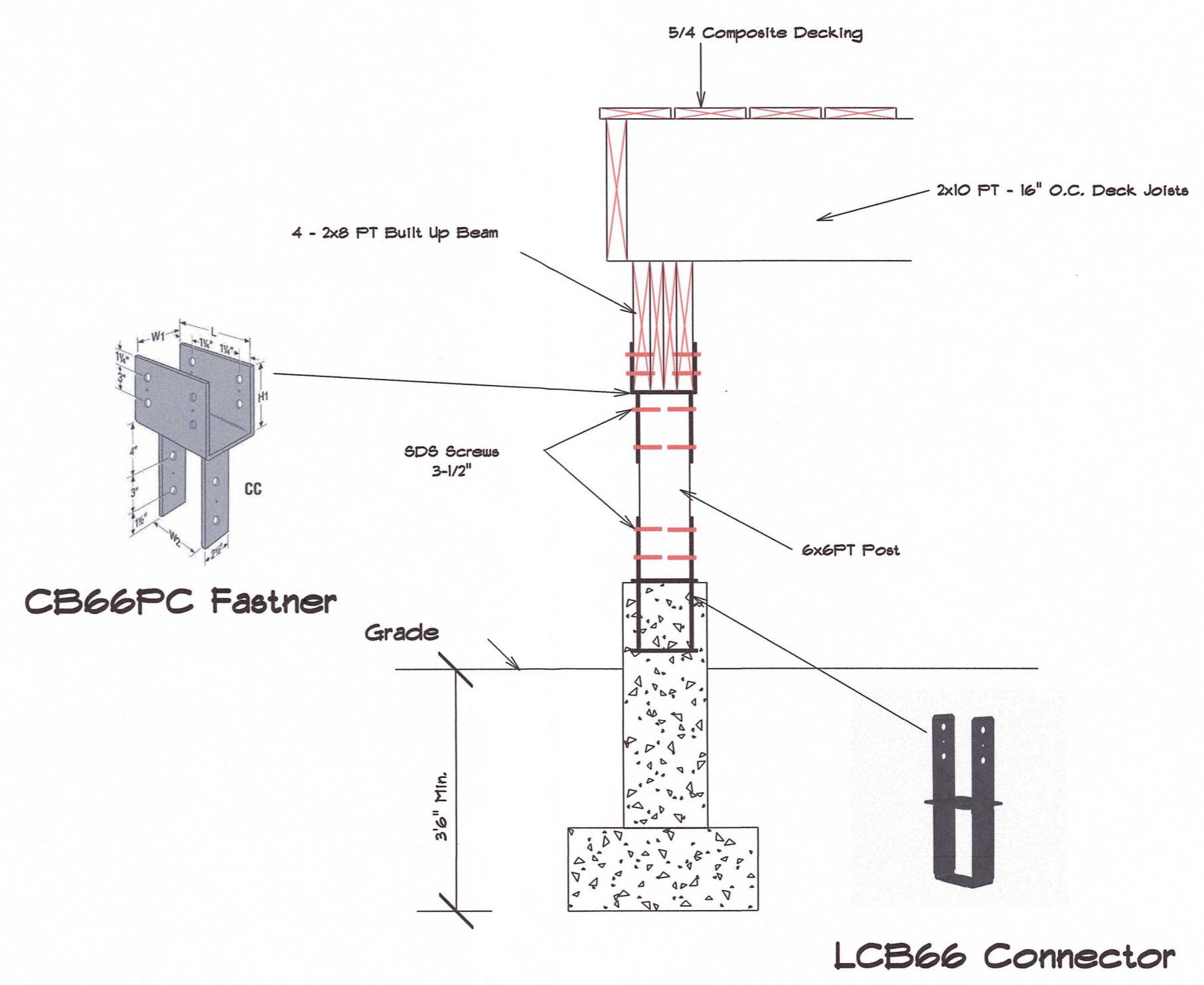

# Typical Detail

## Stair Detail

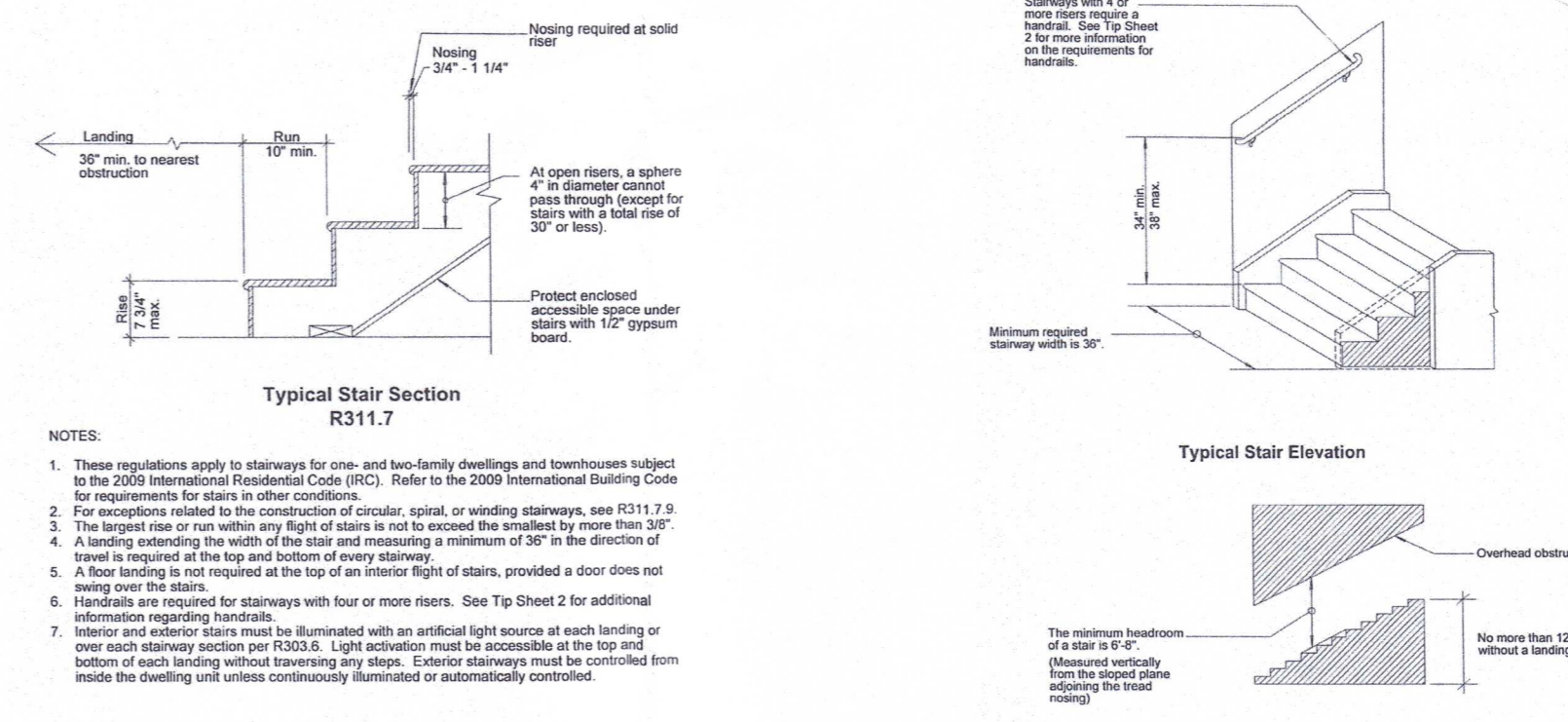

# Window Details

**Window Fall Protection**

Applies to windows where bottom of opening is more than 12\"/>

AND bottom of opening is < 24\"/>

No requirements apply if:

- glazing is fixed (non operable); or,
- > 24\"/>

- Any operable glazing C4\"/>

**Window Opening Limiting Devices**

- Self Acting (automatic)
- Prohibit passage of a 4\"/>
- Emergency escape operation must include a release mechanism
- Operates without tools or keys
- Operates without special knowledge
- Operates in all weather conditions
- Requires < 15 lbs of force to operate
- Minimum net clear openings for emergency escape must be achievable

**Egress Windows Section R310 IRC 2015**

**R310.2.2 Window Sill Height**  
Where a window is provided as the emergency escape and rescue opening, it shall have a sill height of not more than 44 inches (1118mm) above the floor; where the sill height is below grade, it shall be provided with a window well in accordance with Section R310.2.3

**R310.2.1 Minimum Opening Area**  
Emergency and escape rescue openings shall have a net clear opening of not less than 5.7 square feet (0.53x0.2). The net clear opening dimensions required by this section shall be obtained by the normal operation of the emergency escape and rescue opening from the inside. The net clear height shall be not less than 24 inches (610 mm) and the net clear width shall be not less than 20 inches (508mm).

**R310.1.1 Operational Constraints**  
Emergency escape and rescue openings shall be operational from the inside of the room without the use of keys, tools, or special knowledge. Window opening control devices complying with ASTM F 2090 shall be permitted for use on windows serving as a required emergency escape and rescue opening

# Cut Section - A

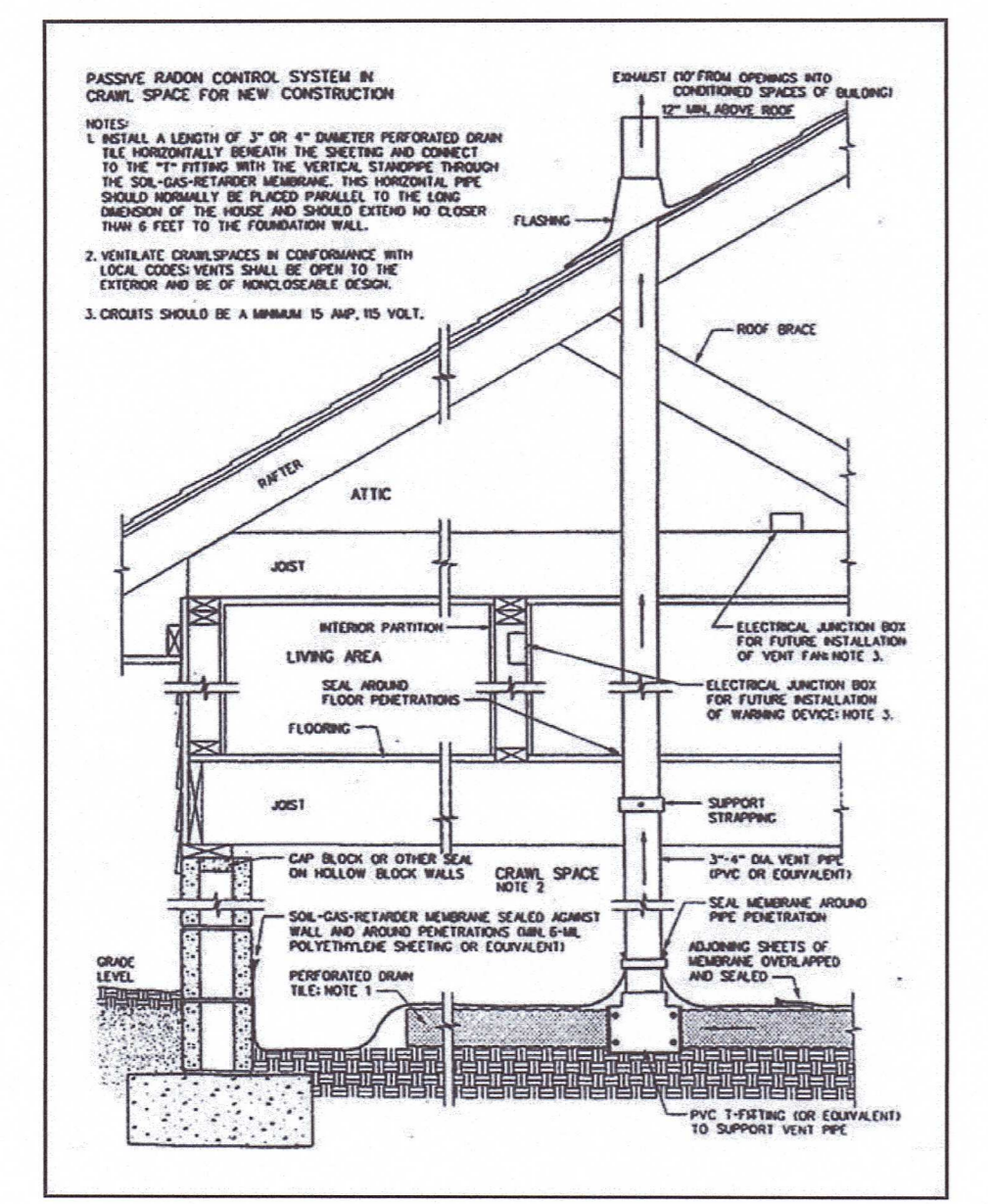
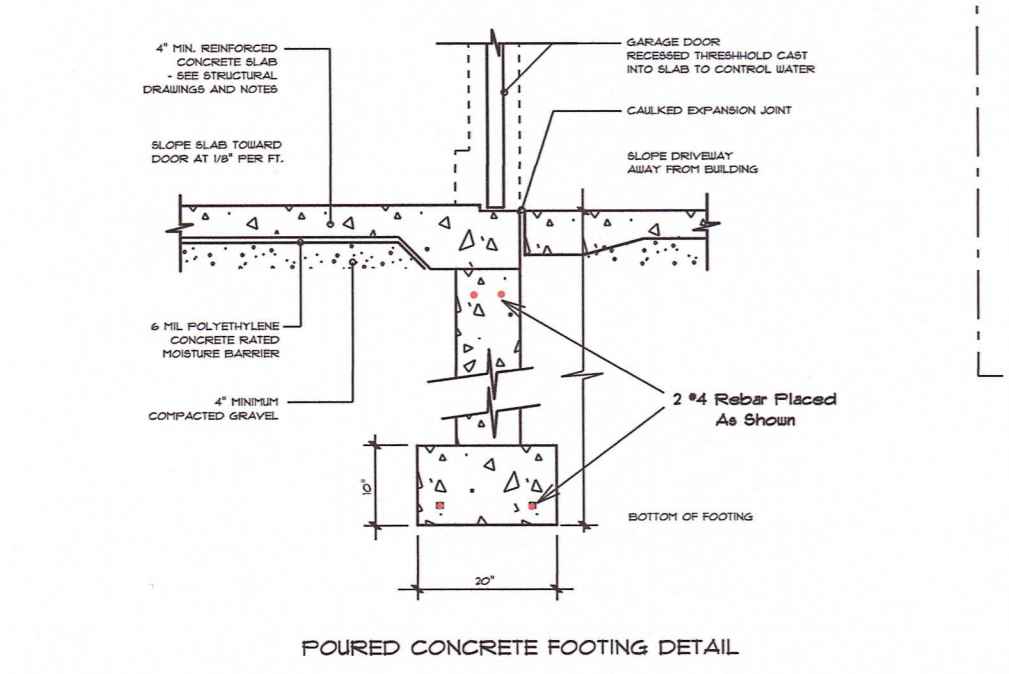

# Deck Details

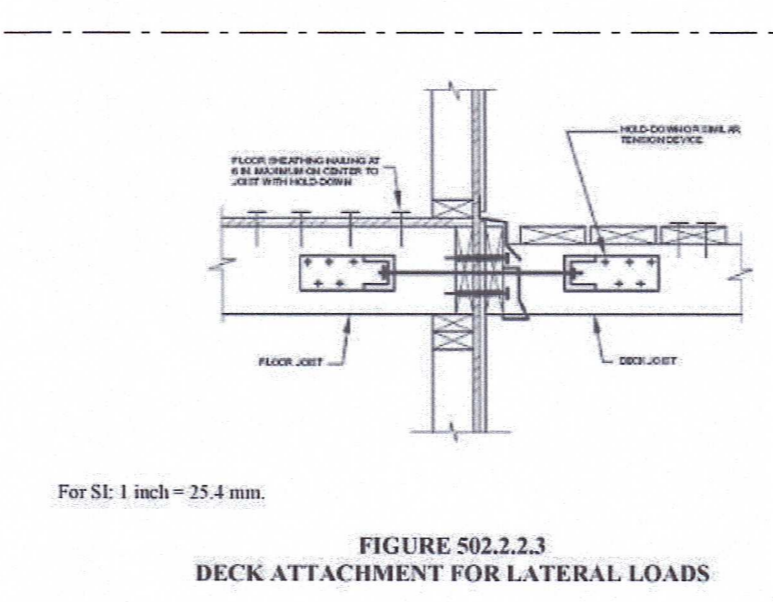
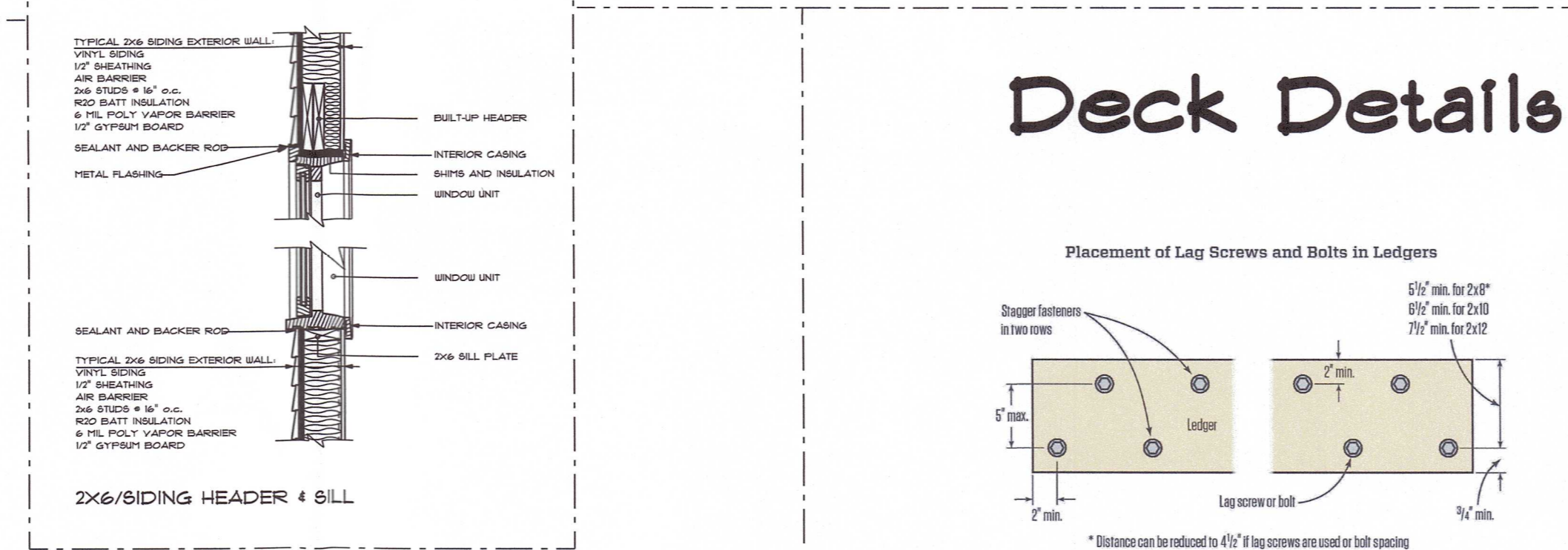

Revision	By

May 12, 2022  
Scale = 1/4" = 1'0"  
Drawn By BPH  
Page 6 of 7

**Home Designs By Bruno**  
See Me Before You Build!

75 Lebanon Ave  
Colchester, CT 06415  
860-885-6199  
860-603-2622 fax

NAAB  
MAKEOVER HOME EDITION  
AIBD