

Meeting Agenda of the Eastern Region WUCC Online via Microsoft Teams

[Eastern Water Utility Coordinating Committee Meeting |
Meeting-Join | Microsoft Teams](#)

Wednesday, September 3, 2025
11:00 AM to 1:00 PM

1. Welcome & Roll Call
2. Proposed ESA Modification – Ledyard (see attachments)
 - Presentation of map
 - Member comments
 - “Affected Municipality” comments
 - Public comments
 - Consensus of WUCC determination (per Eastern WUCCC bylaws)
 - Acknowledgement of receipt of the notification by the WUCC chairs to DPH
3. Nomination and Election of Officers – Tri-chairs (3) OR Co-Chairs (2) and Secretary (1) to serve two-year terms
4. CPCN Projects/WUCC Recommendations
 - Stonington: General Dynamics
 - Thompson: Shanti Village
 - Montville: Cricket’s Corner
5. Activities in Member ESAs/Towns
7. New Business
 - DPH briefing on cybersecurity
 - DPH briefing on mapping and data enhancements
 - DPH update on statewide WUCC implementation activities and future of WUCCs
8. Correspondence
9. Public Comment
10. Next Meeting
11. Adjourn

To: WUCC

From: Ledyard WPCA, SCWA

SUBJ: Modification of Established ESA Boundaries

Enclosures:

Encl 1 939 Long Cove Road

Encl 2 84 Silas Dean Road

Encl 3 WPCA-SCWAswapJuly2025_2

The ESAs held by the Town of Ledyard Water Pollution Control Authority (WPCA) and the Southeastern Connecticut Water Authority (SCWA) in the Town of Ledyard were declared as part of the Eastern Water Utility Coordination Committee (WUCC) Plan Adopted in July of 2016 and confirmed in May of 2017.

To best support the vision captured in the Ledyard Comprehensive Plan and the Ledyard Plan of Conservation and Development, a revision to the ESA boundaries has been agreed upon between the WPCA and SCWA and endorsed by the Mayor of the Town of Ledyard.

Modification of assigned ESA boundaries between two members can be made without the vote of the WUCC provided such modification is documented by the affected members and following an opportunity for comment by the WUCC and any affected municipality.

Two changes support SCWA providing public water to planned residential subdivisions where the WPCA lacks infrastructure.

The first is 939 Long Cove Road (Map-Block-Lot 107-1340-939). SCWA has a water main abutting this planned development from their Tower Division with adequate quality and quantity to support this development. (see Encl 1 939 Long Cove Road)

The second is 84 Silas Deane Road (Map-Block-Lot 42-2220-84). SCWA has a water main abutting this planned development from their Ledyard Center Division with adequate quality and quantity to support this development (Encl 2 84 Silas Dean Road)

The last change supports the contemplated mixed-use development in Ledyard Center where SCWA lacks the infrastructure to supply fire protection and Ledyard WPCA has recently installed infrastructure for sewer services including Colby Drive exclusive of 1 Colby Drive and the intersection of Fairway and Colby Drive as described in detail by Encl 3 WPCA-

SCWASwapJuly2025_2 that depicts graphically the before and after the swap including a table that lists the lot ID's of each lot exchanged.

 7/10/25

Fred Allyn, III

Date

Mayor, Town of Ledyard

 7/10/25

Josh Cansler

Date

Manager, Southeastern Connecticut Water Authority

 7/10/2025

Ed Lynch, P.E.

Date

Chairman, Ledyard WPCA

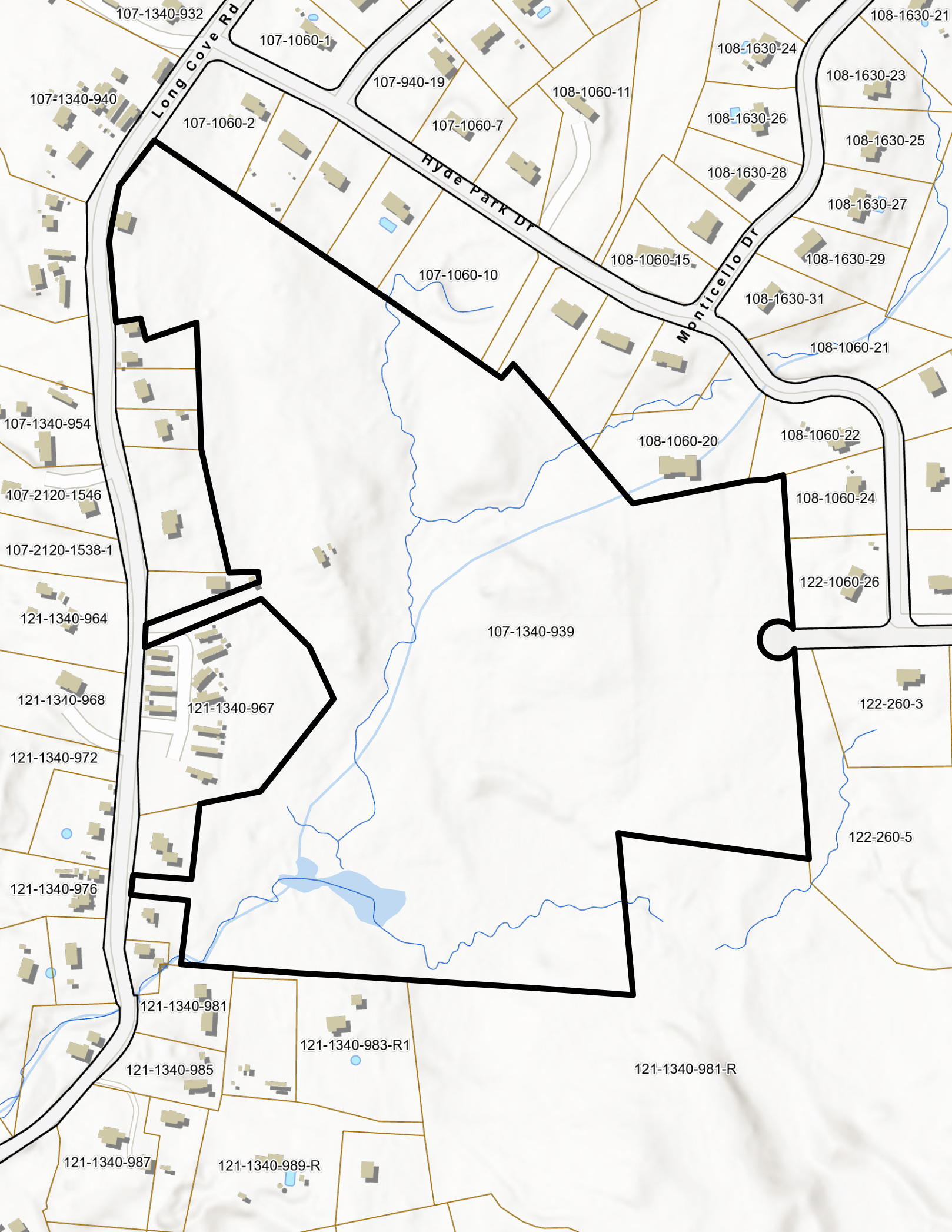

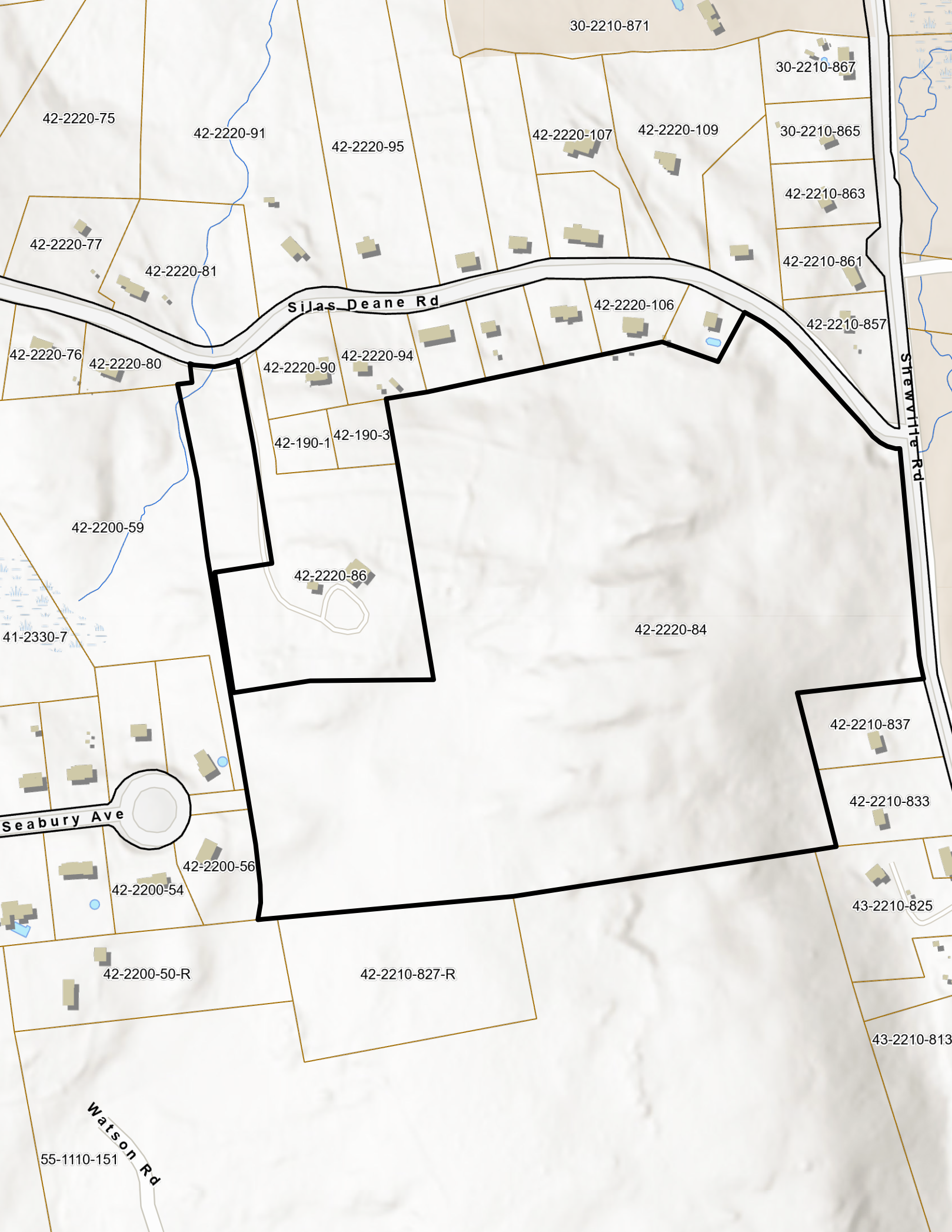

30-2210-871

30-2210-867

42-2220-75

42-2220-91

42-2220-95

42-2220-107

42-2220-109

30-2210-865

42-2210-863

42-2210-861

Silas Deane Rd

42-2220-106

42-2210-857

Shewville Rd

42-2220-76

42-2220-80

42-2220-90

42-2220-94

42-190-1

42-190-3

42-2200-59

42-2220-86

42-2220-84

42-2210-837

42-2210-833

Seabury Ave

42-2200-56

42-2200-54

42-2200-50-R

42-2210-827-R

43-2210-825

43-2210-813

55-1110-151

Watson Rd

Current SCWA service area July 2025.

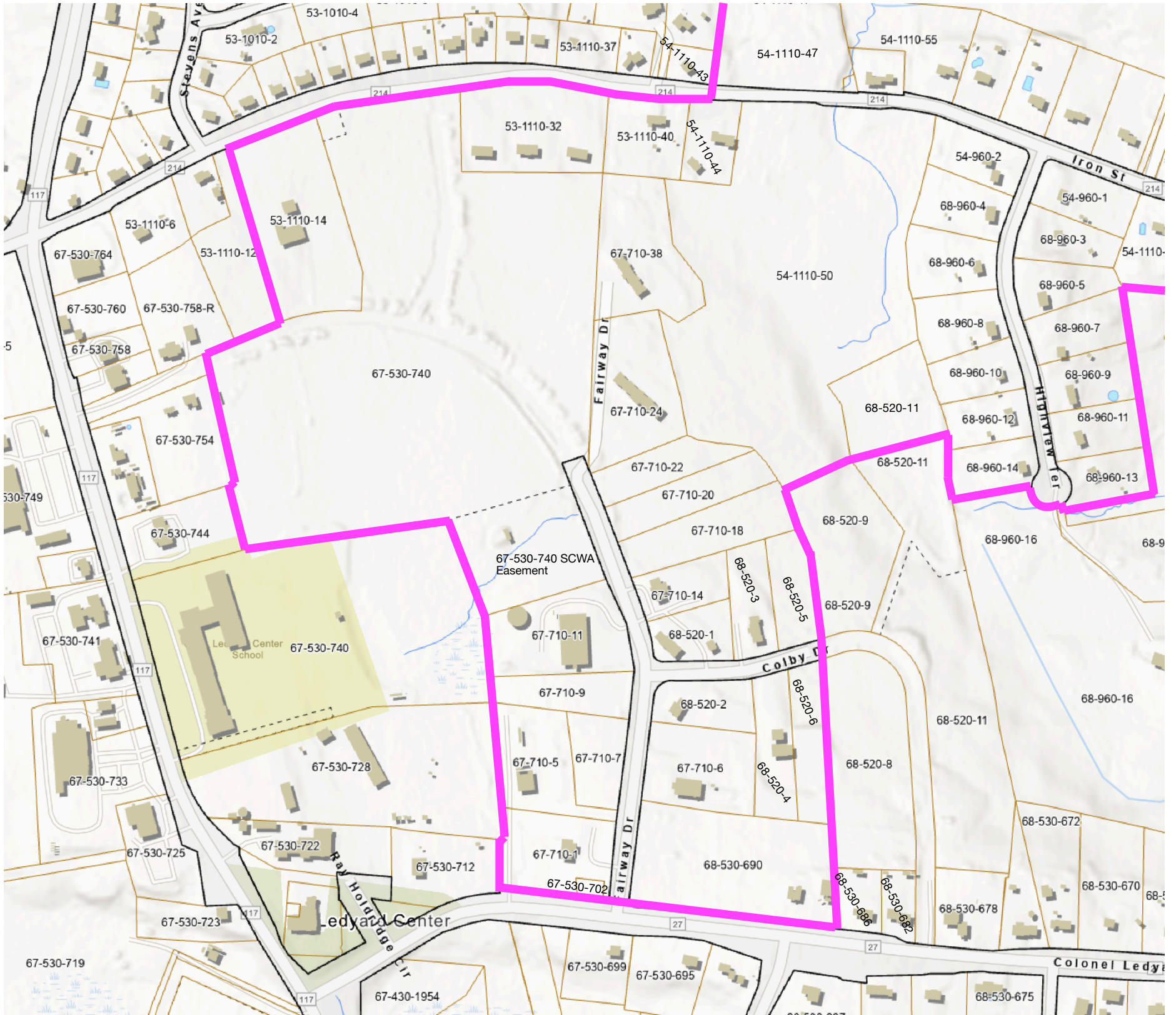

Ledyard center boundaries taken from maps in the “*TOWN OF LEDYARD / WATER POLLUTION CONTROL AUTHORITY WATER SUPPLY PLAN 2016 UPDATE VOLUME I*” as prepared by Groton Utilities.

SCWA boundary outlined in magenta lines —

Proposed Changes between WPCA & SCWA service areas for Ledyard Center, July 2025.

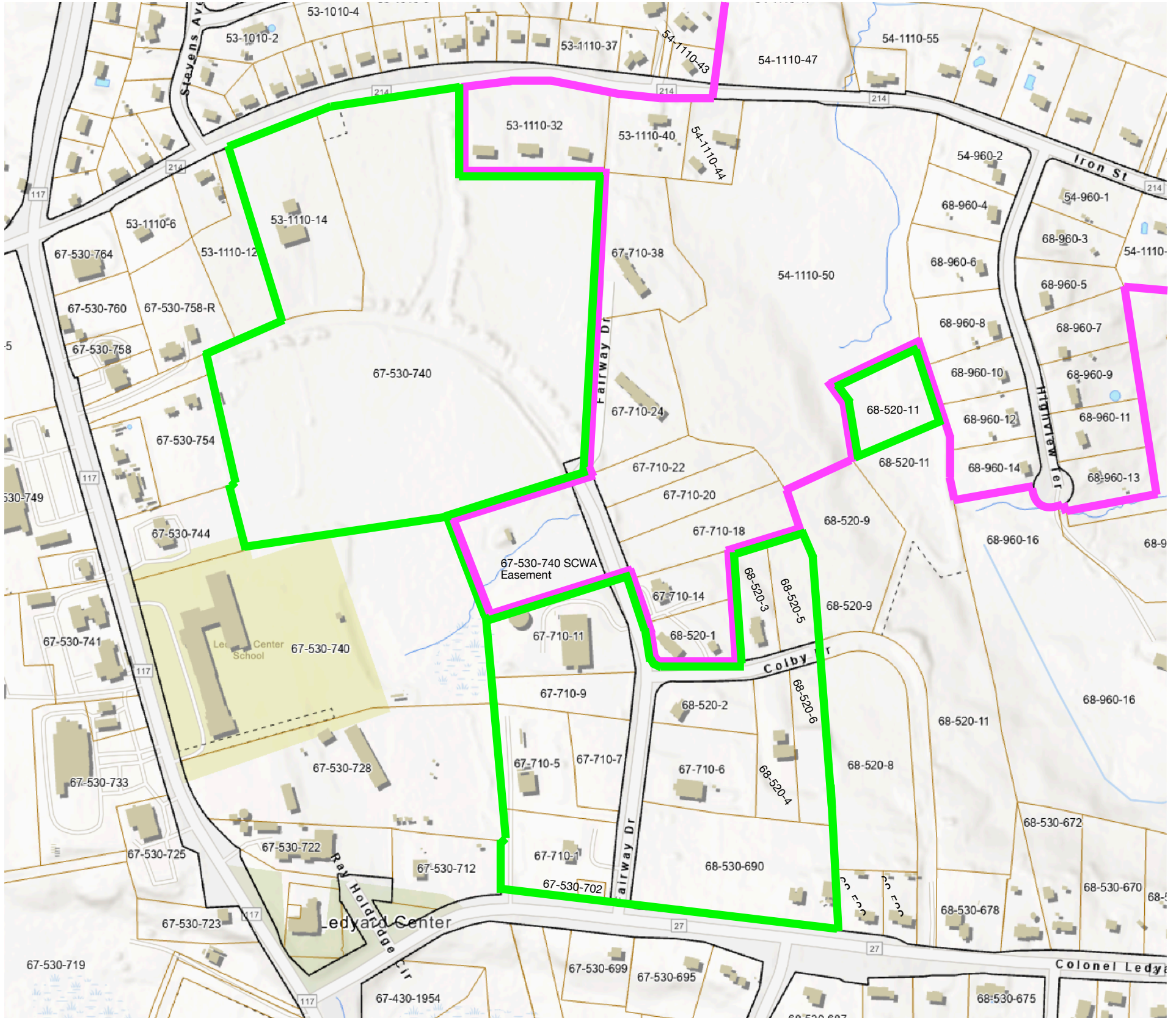

Remaining SCWA boundary outlined in magenta lines —

New WPCA boundary outlined in green lines —

All impacted parcels are listed on the following page with the same color code.

Proposed Changes between WPCA & SCWA service areas for Ledyard Center, July 2025.

Remaining SCWA boundary highlighted in **magenta**.

New WPCA boundary highlighted in **green**.

Unchanged WPCA parcels left in gray.

Current & Proposed Service Provider for Center Ledyard, June 2025

address	parcel	Current	Proposed	Notes
11 Fairway Dr	67-710-11	WPCA & SCWA	WPCA	Fire Station: WPCA feeds sprinklers only. Complete switch to WPCA to include domestic water.
9 Fairway Dr	67-710-9	SCWA	WPCA	
7 Fairway Dr	67-710-7	SCWA	WPCA	Geer Automotive
6 Fairway Dr	67-710-6	SCWA	WPCA	Victory Bible Baptist Church
5 Fairway Dr	67-710-5	SCWA	WPCA	Floyd's Automotive
1 Fairway Dr	67-710-1	SCWA	WPCA	B Covenant Presbyterian Church
11 Colby Dr	68-520-5	WPCA & SCWA	WPCA	The very northern portion of this parcel, next to 10 Highview Terrace, is in SCWA territory.
6 Colby Dr	68-520-6	SCWA	WPCA	
5 Colby Dr	68-520-5	SCWA	WPCA	
4 Colby Dr	68-520-4	SCWA	WPCA	Anderson Oil
3 Colby Dr	68-520-3	SCWA	WPCA	
2 Colby Dr	68-520-2	SCWA	WPCA	
740 Colonel Ledyard Hwy	67-530-740	SCWA	WPCA	Southern portion along Colonel Ledyard Hwy is currently in WPCA
702 Colonel Ledyard Hwy	67-530-702	SCWA	WPCA	A Spicer Cemetery
690 Colonel Ledyard Hwy	67-530-690	SCWA	WPCA	
14 Iron St	53-1110-14	SCWA	WPCA	Aquatic Sports (pool). Would become an isolated SCWA parcel after the conversion of 740 Colonel Ledyard to WPCA.
9 Colby Dr	68-520-9	WPCA	WPCA	
8 Colby Dr	68-520-8	WPCA	WPCA	
686 Colonel Ledyard Hwy	67-530-686	WPCA	WPCA	
712 Colonel Ledyard Hwy	67-530-712	WPCA	WPCA	
740 Colonel Ledyard SCWA Easement	67-530-740	SCWA	SCWA	SCWA Easement, well is located on this portion of 740 Colonel Ledyard, just north of 11 Colby.
1 Colby Dr.	68-520-1	SCWA	SCWA	
50 Iron St	54-1110-50	SCWA	SCWA	
32 Iron St.	53-1110-32	SCWA	SCWA	
38 Fairway Dr.	67-710-38	SCWA	SCWA	
24 Fairway Dr.	67-710-24	SCWA	SCWA	
14 Fairway Dr.	67-710-14	SCWA	SCWA	