

EXHIBIT # 27
MAY 09 2023
APPLICATION #

(P223-4 + 23-5)

79 Elm Street • Hartford, CT 06106-5127

www.ct.gov/deep

Affirmative Action/Equal Opportunity Employer

Generated by eNDDDB on:
5/8/2023

SUSAN MARQUARDT
LOUREIRO ENGINEERING ASSOCIATES, INC.
15 Thames St
Groton, CT 06340
SRMARQUARDT@LOUREIRO.COM

RECEIVED

MAY 09 2023

LAND USE DEPARTMENT

Subject: Gales Ferry Intermodal
Filing # 98093
NDDB – New Determination Number: 202304072
1761 ROUTE 12
GALES FERRY

Expiration Date: 5/8/2025

Based on current data maintained by the Natural Diversity Database (NDDDB) and housed in the DEEP ezFile portal, no extant populations of Federal or State Endangered, Threatened or Special Concern species (RCSA Sec. 26-306) are known to occur within the project area delineated for the Building and Infrastructure Development (including stormwater discharge associate with construction) / New Commercial, Industrial, Governmental, Gales Ferry Intermodal.

This NDDB – New determination may be utilized to fulfill the Endangered and Threatened Species requirements for state-issued permit applications, licenses, registration submissions, and authorizations. However, please be aware of the following limitations and conditions:

- This determination does not preclude the possibility that listed species may be encountered on site. Should this occur, a report must be submitted to the Natural Diversity Database promptly and additional action may be necessary to remain in compliance with certain state permits. Please fill out the appropriate survey form and follow the instructions for submittal.
- If your project involves preparing an Environmental Impact Assessment, this NDDB consultation and determination should not be substituted for conducting biological field surveys assessing on-site habitat and species presence.
- This determination applies only to the project as described in the submission and summarized at the end of this letter. Please re-submit an updated Request for Review if the project's scope of work and/or timeframe changes, including if work has not begun by 5/8/2025.

The NDDB – New determination for the Gales Ferry Intermodal at 1761 ROUTE 12, GALES FERRY as described in the submitted information and summarized at the end of this document is valid for two years from the date on this letter.

Natural Diversity Database information includes all information regarding listed species available to us at the time of the request. This information is a compilation of data collected over the years by the Department of Energy and Environmental Protection's Natural History Survey and cooperating units of DEEP, land owners, private conservation groups and the scientific community. This information is not necessarily the result of comprehensive or site-specific field investigations. Current research projects and new contributors continue to identify additional populations of species and locations of habitats of concern, as well as, enhance existing data. Such new information is incorporated into the Database and accessed through the ezFile portal as it becomes available.

This letter is computer generated and carries no signature. If however, any clarification is needed, or if you have further questions, please contact the following:

CT DEEP Bureau of Natural Resources
Wildlife Division
Natural Diversity Database
79 Elm Street, 6th floor
Hartford, CT 06106-5127
(860) 424-3011
deep.nddbrequest@ct.gov

Please reference the Determination Number provided in this letter when you e-mail or write. Thank you for submitting your project through DEEP's ezFile portal for Natural Diversity Database reviews.

Application Details:

Project involves federal funds or federal permit:	No
Project involves state funds, state agency action, or relates to CEPA request:	No
Project requires state permit, license, registration, or authorization:	No
DEEP enforcement action related to project:	
Project Type:	Building and Infrastructure Development (including stormwater discharge associate with construction)
Project Sub-type:	New Commercial, Industrial, Governmental
Project Name:	Gales Ferry Intermodal
Project Description:	

Gales Ferry Intermodal Map

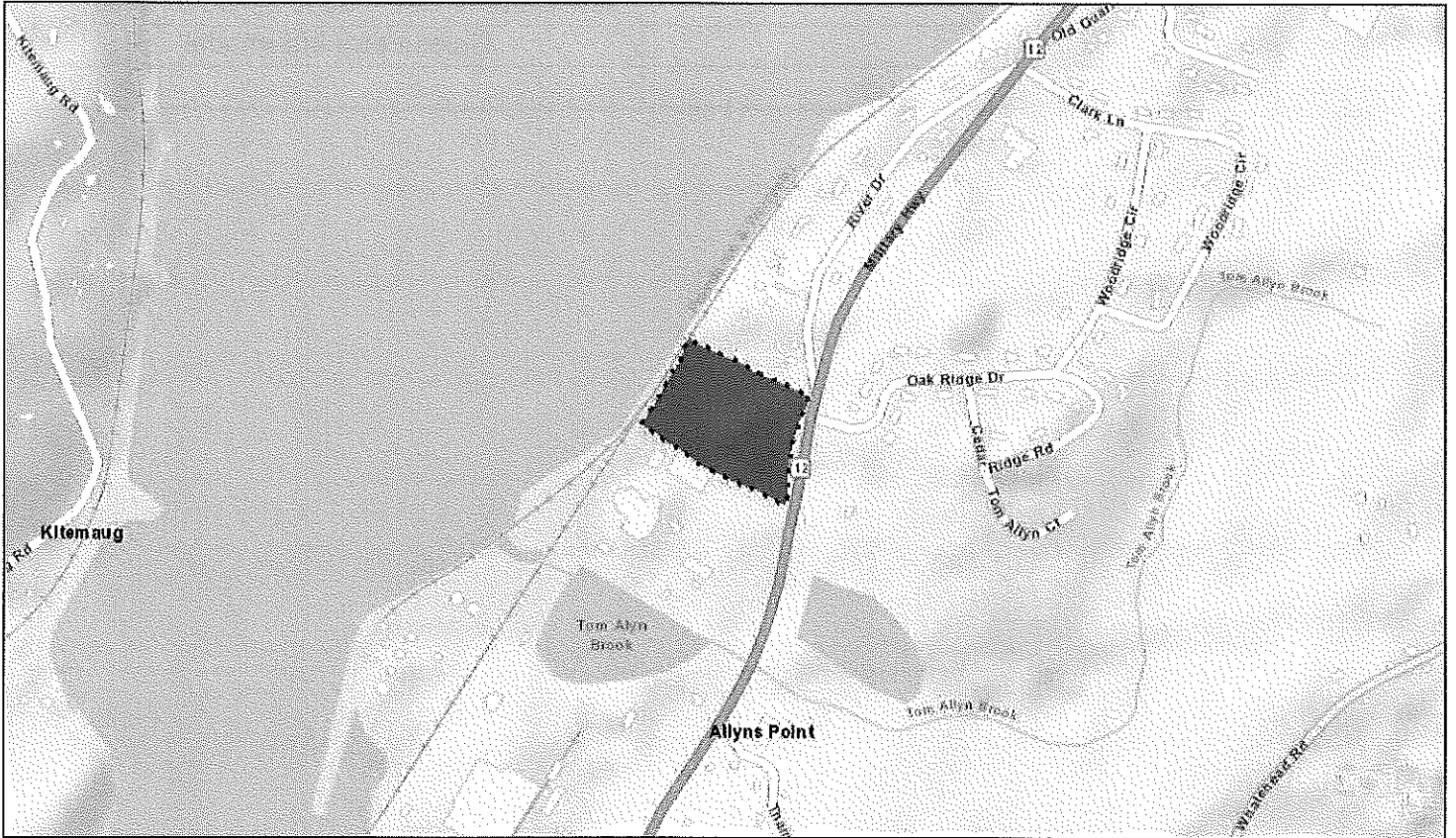

May 8, 2023

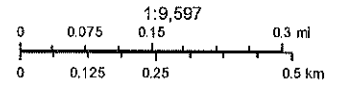

Sources: Esri, HERE, Garmin, USGS, Intermap, INCREMENT P, NRCan, Esri Japan, METI, Esri China (Hong Kong), Esri Korea, Esri (Thailand), NGCC, (c) OpenStreetMap contributors, and the GIS User Community